

220V 50 1~



GENERAL DATA

Application: HBP
Refrigerant: R134a
Evaporating Temperature Range: -15°C to 10°C
Compressor Cooling: Fan
Fan air flow: 520 m³/h
Type: Hermetic reciprocating
Technology Type: On-Off
Expansion Device: Capillary Tube or Expansion Valve
Packing Quantity: Multi - 36 pcs
Displacement: 17.4 cm³
Horse power: 1.2 hp

Approvals:   

MECHANICAL DATA

Bore: 34.12 mm
Stroke: 19.03 mm
Oil Charge: 450ml +/-15ml
Free Internal Volume: 3.3 cm³
Maximum Recommended Refrigerant Charge: 800 g
Oil Type Configuration: Polyolester
Oil Type Viscosity: ISO22
Compressor pressurization: Dry air charge
Weight: 14.9 kg

ELECTRICAL DATA

Motor Type: CSIR
Starting Torque: HST
Voltage working range at 50 Hz: 200-242 V
Maximum Motor Temperature: 130 °C
Start Winding Resistance: 20.29 Ω (± 10%) at 25°C
Run Winding Resistance: 3.41 Ω (± 10%) at 25°C

MOUNTING ACCESSORIES

	Description	Code
Anchorage:	no	-
Grommets:	yes	2221004
Sleeves:	yes	2222016
Washer:	no	-
Pin:	no	-
Clip:	no	-
Rotolock valve:	no	-
Cover:	yes	2075282
Terminal Board:	yes	1027060
Overload Protector Bracket:	yes	2075299
Capacitor Bracket:	yes	2255007

ELECTRICAL COMPONENTS

	Component type	Description	Code
Starting Device:	Current relay	MTRP-0048-59	2278036
Motor Protection:	External 3/4"	T0634/G6	2319064
Start Capacitor:		64-77 MFD 330V	2252340

EXTERNAL CHARACTERISTICS

Base Plate: Universal
Tray Holder: No
Height: 207 mm

	Internal Diameter (mm)	Material	Shape
Suction Connector	9.6	Copper	Slanted 42°
Discharge Connector	6.42	Copper	Straight
Process Connector	6.42	Copper	Vertical

RATED POINT DATA

Cooling Capacity (W)	Power Consumption (W)	Current Consumption (A)	Gas Flow Rate (kg/h)	Efficiency (W/W)
±5%	±5%	±5%	±5%	±7%
1 639	701	4.39	36.13	2.34

Test condition: ASHRAE, Fan, Return Gas 35°C, Subcooling 8.3K, Evaporating: 7.2°C, Condensing: 54°C, Ambient: 35°C

PERFORMANCE CURVE DATA

220V 50Hz

Condensing Temperature (°C)	Evaporating Temperature (°C)	Cooling Capacity (W)	Power Consumption (W)	Current Consumption (A)	Gas Flow Rate (kg/h)	Efficiency (W/W)
		±5%	±5%	±5%	±5%	±7%
35°C	10	2 354	574	4.00	44.47	4.10
	5	1 946	548	3.91	36.53	3.55
	0	1 583	520	3.83	29.55	3.05
	-5	1 269	489	3.74	23.57	2.60
	-10	1 007	455	3.65	18.64	2.21
	-15	801	418	3.57	14.79	1.91

Condensing Temperature (°C)	Evaporating Temperature (°C)	Cooling Capacity (W)	Power Consumption (W)	Current Consumption (A)	Gas Flow Rate (kg/h)	Efficiency (W/W)
		±5%	±5%	±5%	±5%	±7%
45°C	10	2 076	660	4.24	42.44	3.15
	5	1 716	619	4.11	34.85	2.77
	0	1 392	578	3.98	28.12	2.41
	-5	1 109	535	3.85	22.29	2.07
	-10	870	491	3.73	17.40	1.77
	-15	678	445	3.62	13.51	1.52

Condensing Temperature (°C)	Evaporating Temperature (°C)	Cooling Capacity (W)	Power Consumption (W)	Current Consumption (A)	Gas Flow Rate (kg/h)	Efficiency (W/W)
		±5%	±5%	±5%	±5%	±7%
55°C	10	1 792	738	4.52	40.06	2.43
	5	1 478	684	4.33	32.79	2.16
	0	1 192	630	4.14	26.27	1.89
	-5	938	576	3.97	20.55	1.63
	-10	719	521	3.82	15.68	1.38

Test condition: ASHRAE, Fan, Return Gas 35°C, Subcooling 8.3K, Ambient: 35°C

ASSEMBLY INSTRUCTION

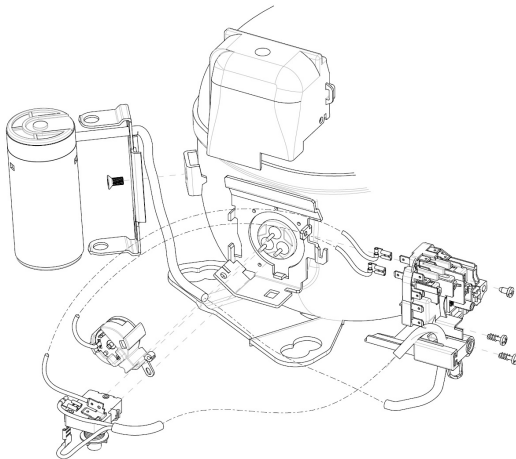

WIRING DIAGRAM

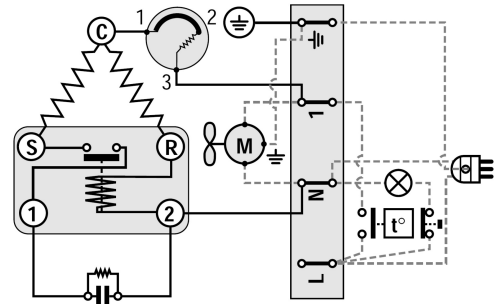

OPERATING ENVELOPE

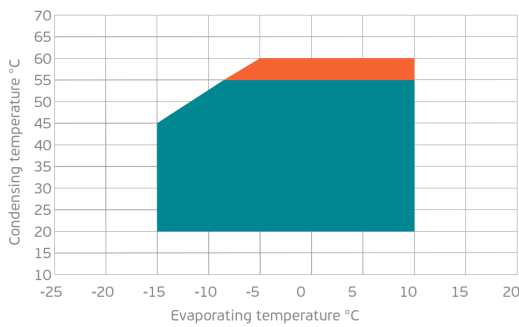

- Operating Condition
- Transient Condition
- Superheating

NOTE: usage of compressors outside of intended working range cannot make use of the warranty, or should be consulted with Technical support.

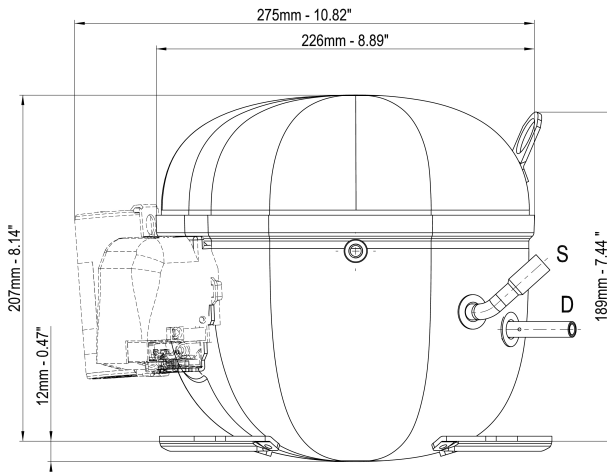

	∅ mm	∅ in	Material
S - Suction	9.60	0.37	Cu
P - Process	6.42	0.25	Cu
D - Discharge	6.42	0.25	Cu

