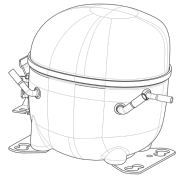

**115V 60 1~****GENERAL DATA**

**Application:** LBP  
**Refrigerant:** R134a  
**Evaporating Temperature Range:** -30°C to -5°C  
**Compressor Cooling:** Static  
**Type:** Hermetic reciprocating  
**Technology Type:** On-Off  
**Expansion Device:** Capillary Tube or Expansion Valve  
**Packing Quantity:** Multi - 37 pcs  
**Displacement:** 7.37 cm<sup>3</sup>  
**Horse power:** 1.5 hp

Approvals:   

**MECHANICAL DATA**

**Bore:** 24.28 mm  
**Stroke:** 15.92 mm  
**Oil Charge:** 350ml +/-15ml  
**Free Internal Volume:** 2.1 cm<sup>3</sup>  
**Maximum Recommended Refrigerant Charge:** 350 g  
**Oil Type Configuration:** Polyolester  
**Oil Type Viscosity:** ISO22  
**Compressor pressurization:** Dry air charge  
**Weight:** 10.1 kg

**ELECTRICAL DATA**

**Motor Type:** CSIR  
**Starting Torque:** HST  
**Voltage working range at 60 Hz:** 103-127 V  
**Maximum Motor Temperature:** 130 °C  
**Start Winding Resistance:** 8.3 Ω (± 10%) at 25°C  
**Run Winding Resistance:** 2 Ω (± 10%) at 25°C  
**Locked Rotor Amperage (LRA):** 22 A

**MOUNTING ACCESSORIES**

	Description	Code
<b>Terminal Board:</b>	no	-
<b>Anchorage:</b>	no	-
<b>Washer:</b>	no	-
<b>Pin:</b>	no	-
<b>Clip:</b>	no	-
<b>Rotolock valve:</b>	no	-
<b>Overload Protector Bracket:</b>	yes	2075299
<b>Capacitor Bracket:</b>	yes	2255007
<b>Cover:</b>	yes	2075278
<b>Grommets:</b>	yes	2221003
<b>Sleeves:</b>	yes	2222015

**ELECTRICAL COMPONENTS**

	Component type	Description	Code
<b>Starting Device:</b>	Current relay	MTRPH-0048-31	2271160
<b>Start Capacitor:</b>		145-174 MFD 250V	2252282
<b>Motor Protection:</b>	External 3/4"	T0919/J5	2324116

**EXTERNAL CHARACTERISTICS**

**Base Plate:** Universal  
**Tray Holder:** No  
**Height:** 188 mm

	Internal Diameter (mm)	Material	Shape
<b>Suction Connector</b>	8.1	Copper	Slanted 42°
<b>Discharge Connector</b>	6.45	Copper	Straight
<b>Process Connector</b>	6.45	Copper	Slanted 42°

**RATED POINT DATA**

Cooling Capacity (W)	Power Consumption (W)	Current Consumption (A)	Gas Flow Rate (kg/h)	Efficiency (W/W)
±5%	±5%	±5%	±5%	±7%
171	188	2.96	4.49	0.91

Test condition: ARI 540, Static, Return Gas 4.4°C, Subcooling OK, Evaporating: -23.3°C, Condensing: 49°C, Ambient: 35°C

**PERFORMANCE CURVE DATA****115V 60Hz**

Condensing Temperature (°C)	Evaporating Temperature (°C)	Cooling Capacity (W)	Power Consumption (W)	Current Consumption (A)	Gas Flow Rate (kg/h)	Efficiency (W/W)
		±5%	±5%	±5%	±5%	±7%
<b>35°C</b>	-5	543	273	3.45	12.62	1.99
	-10	441	246	3.26	10.19	1.79
	-15	351	221	3.10	8.06	1.59
	-20	272	196	2.96	6.22	1.38
	-25	204	172	2.84	4.66	1.19
	-30	148	148	2.72	3.35	1.00

Condensing Temperature (°C)	Evaporating Temperature (°C)	Cooling Capacity (W)	Power Consumption (W)	Current Consumption (A)	Gas Flow Rate (kg/h)	Efficiency (W/W)
		±5%	±5%	±5%	±5%	±7%
<b>45°C</b>	-5	481	293	3.54	12.39	1.64
	-10	385	261	3.35	9.82	1.47
	-15	300	231	3.18	7.61	1.30
	-20	229	203	3.03	5.76	1.12
	-25	169	177	2.89	4.25	0.96
	-30	122	152	2.77	3.07	0.80

Condensing Temperature (°C)	Evaporating Temperature (°C)	Cooling Capacity (W)	Power Consumption (W)	Current Consumption (A)	Gas Flow Rate (kg/h)	Efficiency (W/W)
		±5%	±5%	±5%	±5%	±7%
<b>55°C</b>	-5	422	314	3.68	12.21	1.34
	-10	328	276	3.47	9.41	1.19
	-15	247	241	3.28	7.05	1.03
	-20	180	210	3.10	5.10	0.86
	-25	127	181	2.94	3.57	0.70

Test condition: ARI 540, Static, Return Gas 4.4°C, Subcooling OK, Ambient: 35°C

**ASSEMBLY INSTRUCTION**

**WIRING DIAGRAM**

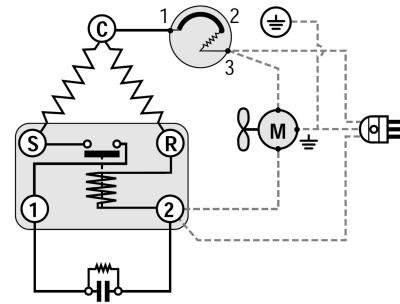
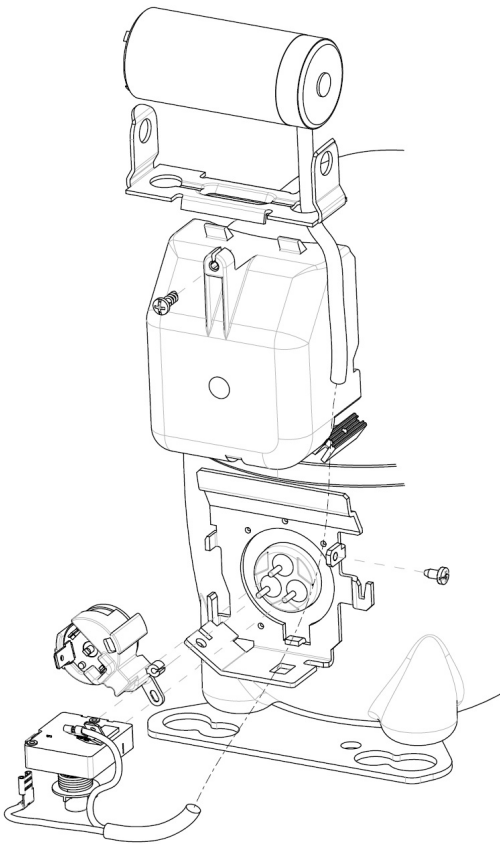

**OPERATING ENVELOPE**

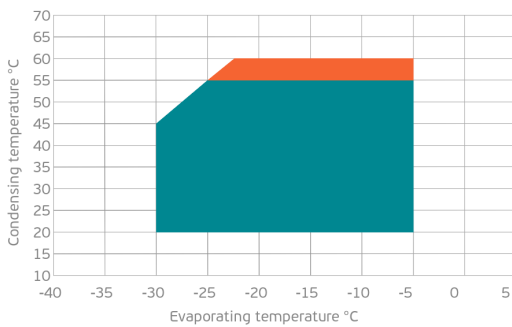

- Operating Condition
- Transient Condition
- Superheating

**NOTE:** usage of compressors outside of intended working range cannot make use of the warranty, or should be consulted with Technical support.

