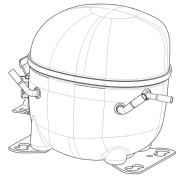

208-230V 60 1~**GENERAL DATA**

Application: MBP
Refrigerant: R404A
Evaporating Temperature Range: -20°C to 10°C
Compressor Cooling: Fan
Fan air flow: 520 m³/h
Type: Hermetic reciprocating
Technology Type: On-Off
Expansion Device: Capillary Tube or Expansion Valve
Packing Quantity: Single - 1 pc
Displacement: 8.77 cm³
Horse power: 1.2 hp

Approvals:    

MECHANICAL DATA

Bore: 26.5 mm
Stroke: 15.92 mm
Oil Charge: 350ml +/-15ml
Free Internal Volume: 2.1 cm³
Maximum Recommended Refrigerant Charge: 350 g
Oil Type Configuration: Polyolester
Oil Type Viscosity: ISO22
Compressor pressurization: Dry air charge
Weight: 11.5 kg

ELECTRICAL DATA

Motor Type: CSIR
Starting Torque: HST
Voltage working range at 60 Hz: 187-244 V
Maximum Motor Temperature: 130 °C
Start Winding Resistance: 20.26 Ω (± 10%) at 25°C
Run Winding Resistance: 3.05 Ω (± 10%) at 25°C
Locked Rotor Amperage (LRA): 23 A

MOUNTING ACCESSORIES

	Description	Code
Terminal Board:	no	-
Anchorage:	no	-
Washer:	no	-
Pin:	no	-
Clip:	no	-
Rotolock valve:	no	-
Overload Protector Bracket:	yes	2075299
Capacitor Bracket:	yes	2255007
Cover:	yes	2075278
Grommets:	yes	2221003
Sleeves:	yes	2222015

ELECTRICAL COMPONENTS

	Component type	Description	Code
Start Capacitor:		53-64 MFD 330V	2252372
Starting Device:	Current relay	MTRPH-58-31	2271127
Motor Protection:	External 3/4"	T0918/J5	2324105

EXTERNAL CHARACTERISTICS

Base Plate: Universal
Tray Holder: No
Height: 206 mm

	Internal Diameter (mm)	Material	Shape
Suction Connector	8.1	Copper	Slanted 42°
Discharge Connector	6.45	Copper	Straight
Process Connector	6.45	Copper	Slanted 42°

RATED POINT DATA

Cooling Capacity (W)	Power Consumption (W)	Current Consumption (A)	Gas Flow Rate (kg/h)	Efficiency (W/W)
±5%	±5%	±5%	±5%	±7%
1 557	731	4.45	43.51	2.13

Test condition: ASHRAE, Fan, Return Gas 35°C, Subcooling 8.3K, Evaporating: 7.2°C, Condensing: 54°C, Ambient: 35°C

PERFORMANCE CURVE DATA**208V 60Hz**

Condensing Temperature (°C)	Evaporating Temperature (°C)	Cooling Capacity (W)	Power Consumption (W)	Current Consumption (A)	Gas Flow Rate (kg/h)	Efficiency (W/W)
		±5%	±5%	±5%	±5%	±7%
35°C	10	2 271	632	4.02	51.71	3.59
	5	1 930	588	3.82	43.43	3.28
	0	1 623	546	3.64	36.15	2.97
	-5	1 349	506	3.46	29.78	2.67
	-10	1 107	467	3.30	24.28	2.37
	-15	898	429	3.15	19.58	2.09
	-20	721	392	3.01	15.60	1.84

Condensing Temperature (°C)	Evaporating Temperature (°C)	Cooling Capacity (W)	Power Consumption (W)	Current Consumption (A)	Gas Flow Rate (kg/h)	Efficiency (W/W)
		±5%	±5%	±5%	±5%	±7%
45°C	10	1 984	699	4.31	50.13	2.84
	5	1 680	649	4.08	41.88	2.59
	0	1 407	600	3.86	34.68	2.34
	-5	1 166	553	3.66	28.45	2.11
	-10	955	507	3.47	23.13	1.88
	-15	775	462	3.28	18.66	1.68
	-20	625	418	3.11	14.96	1.50

Condensing Temperature (°C)	Evaporating Temperature (°C)	Cooling Capacity (W)	Power Consumption (W)	Current Consumption (A)	Gas Flow Rate (kg/h)	Efficiency (W/W)
		±5%	±5%	±5%	±5%	±7%
55°C	10	1 681	770	4.64	47.98	2.18
	5	1 415	713	4.37	39.82	1.98
	0	1 178	657	4.11	32.74	1.79
	-5	971	602	3.87	26.69	1.61
	-10	793	549	3.63	21.59	1.45

Test condition: ASHRAE, Fan, Return Gas 35°C, Subcooling 8.3K, Ambient: 35°C

ASSEMBLY INSTRUCTION

WIRING DIAGRAM

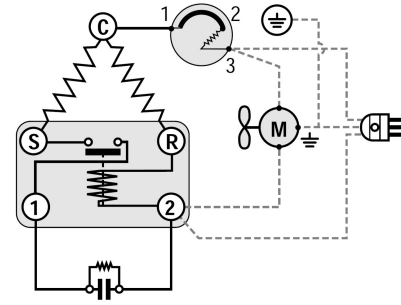
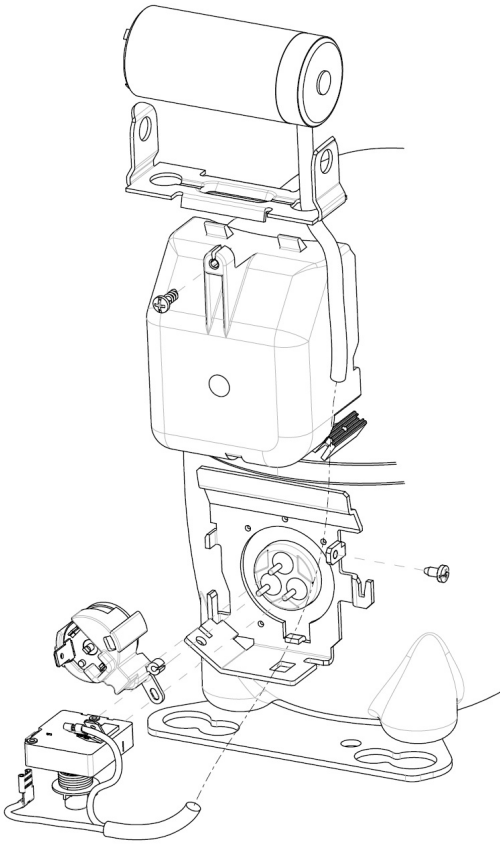

OPERATING ENVELOPE

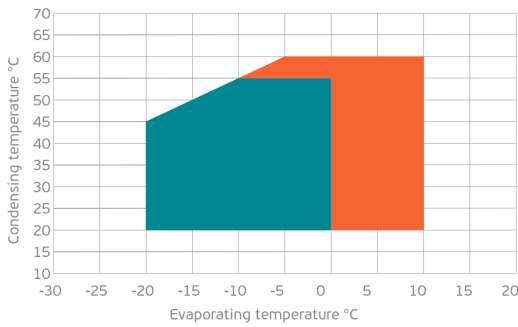

- Operating Condition
- Transient Condition
- Superheating

NOTE: usage of compressors outside of intended working range cannot make use of the warranty, or should be consulted with Technical support.

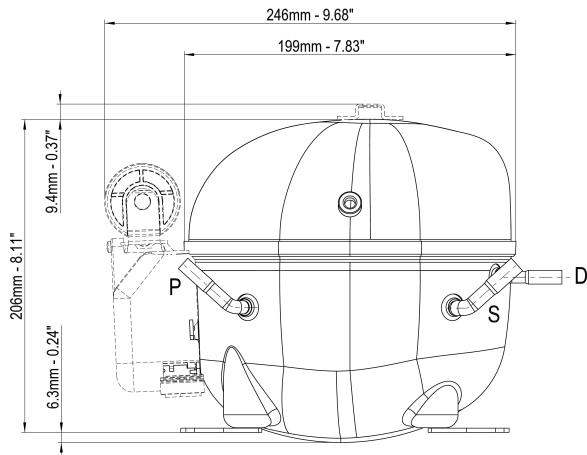

	∅ mm	∅ in	Material
S - Suction	8.10 - 8.20	0.32	Cu
P - Process	6.45 - 6.55	0.25	Cu
D - Discharge	6.45 - 6.55	0.25	Cu

