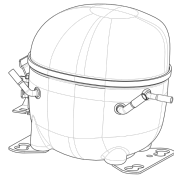

220-240V 50 1~**GENERAL DATA**

Application: MBP
Refrigerant: R290
Evaporating Temperature Range: -20°C to 10°C
Compressor Cooling: Fan
Fan air flow: 520 m³/h
Type: Hermetic reciprocating
Technology Type: On-Off
Expansion Device: Capillary Tube or Expansion Valve
Packing Quantity: Multi - 40 pcs
Displacement: 14.28 cm³
Horse power: 3.4 hp

Approvals:   

MECHANICAL DATA

Bore: 30.16 mm
Stroke: 20 mm
Oil Charge: 350ml +/-15ml
Free Internal Volume: 2.1 cm³
Maximum Recommended Refrigerant Charge: 150 g
Oil Type Configuration: Polyolester
Oil Type Viscosity: ISO22
Compressor pressurization: Without dry air charge
Weight: 12.3 kg

ELECTRICAL DATA

Motor Type: CSR
Starting Torque: HST
Voltage working range at 50 Hz: 198-254 V
Maximum Motor Temperature: 130 °C
Start Winding Resistance: 13.9 Ω (± 10%) at 25°C
Run Winding Resistance: 3.3 Ω (± 10%) at 25°C

MOUNTING ACCESSORIES

	Description	Code
Terminal Board:	no	-
Anchorage:	no	-
Capacitor Bracket:	no	-
Washer:	no	-
Pin:	no	-
Clip:	no	-
Rotolock valve:	no	-
Grommets:	yes	2221011
Sleeves:	yes	2222018
Overload Protector Bracket:	yes	2075299
Cover:	yes	2075278

ELECTRICAL COMPONENTS

	Component type	Description	Code
Starting Device:	Potential relay	RVA4M3C-109	1253012
Start Capacitor:		53-64 MFD 330V	2252261
Run Capacitor:		10 MFD	2253316
Motor Protection:	External 3/4"	T0918/G9 MST20APK-3261	2321135
CSR / CSIR Box:	yes		1272006

EXTERNAL CHARACTERISTICS

Base Plate: European
Tray Holder: No
Height: 206 mm

	Internal Diameter (mm)	Material	Shape
Suction Connector	8.1	Copper	Slanted 42°
Discharge Connector	6.1	Copper	Straight
Process Connector	6.1	Copper	Slanted 42°

RATED POINT DATA

Cooling Capacity (W)	Power Consumption (W)	Current Consumption (A)	Gas Flow Rate (kg/h)	Efficiency (W/W)
±5%	±5%	±5%	±5%	±7%
1 899	737	3.91	22.09	2.58

Test condition: ASHRAE, Fan, Return Gas 35°C, Subcooling 8.3K, Evaporating: 7.2°C, Condensing: 54°C, Ambient: 35°C

PERFORMANCE CURVE DATA

220V 50Hz

Condensing Temperature (°C)	Evaporating Temperature (°C)	Cooling Capacity (W)	Power Consumption (W)	Current Consumption (A)	Gas Flow Rate (kg/h)	Efficiency (W/W)
		±5%	±5%	±5%	±5%	±7%
35°C	10	2 589	610	3.38	25.74	4.24
	5	2 211	583	3.27	21.83	3.79
	0	1 870	555	3.15	18.34	3.37
	-5	1 566	525	3.03	15.27	2.98
	-10	1 298	494	2.91	12.60	2.62
	-15	1 066	462	2.79	10.31	2.31
	-20	871	428	2.66	8.39	2.03

Condensing Temperature (°C)	Evaporating Temperature (°C)	Cooling Capacity (W)	Power Consumption (W)	Current Consumption (A)	Gas Flow Rate (kg/h)	Efficiency (W/W)
		±5%	±5%	±5%	±5%	±7%
45°C	10	2 330	684	3.69	25.12	3.41
	5	1 983	651	3.55	21.20	3.05
	0	1 670	616	3.40	17.73	2.71
	-5	1 392	580	3.25	14.69	2.40
	-10	1 149	542	3.10	12.06	2.12
	-15	940	502	2.94	9.83	1.87
	-20	766	461	2.78	7.98	1.66

Condensing Temperature (°C)	Evaporating Temperature (°C)	Cooling Capacity (W)	Power Consumption (W)	Current Consumption (A)	Gas Flow Rate (kg/h)	Efficiency (W/W)
		±5%	±5%	±5%	±5%	±7%
55°C	10	2 052	769	4.05	24.22	2.67
	5	1 739	726	3.86	20.35	2.40
	0	1 458	681	3.67	16.93	2.14
	-5	1 210	635	3.47	13.96	1.91
	-10	994	586	3.27	11.41	1.70

Test condition: ASHRAE, Fan, Return Gas 35°C, Subcooling 8.3K, Ambient: 35°C

ASSEMBLY INSTRUCTION

WIRING DIAGRAM

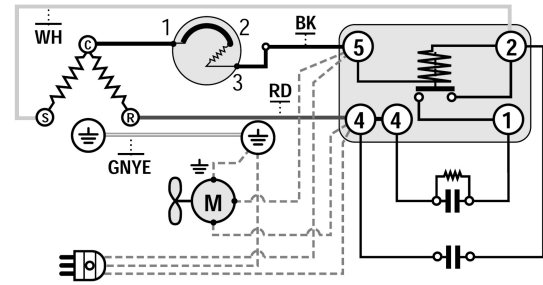
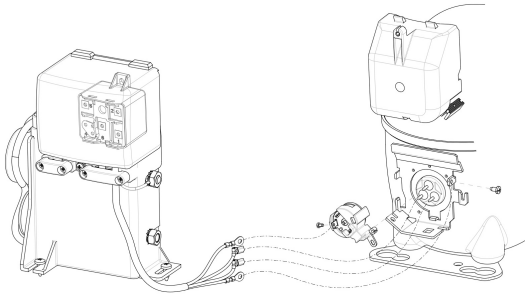

OPERATING ENVELOPE

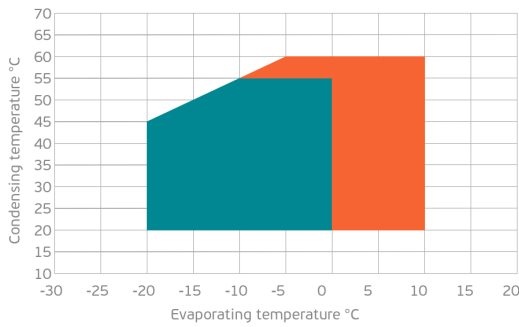

- Operating Condition
- Transient Condition
- Superheating

NOTE: usage of compressors outside of intended working range cannot make use of the warranty, or should be consulted with Technical support.

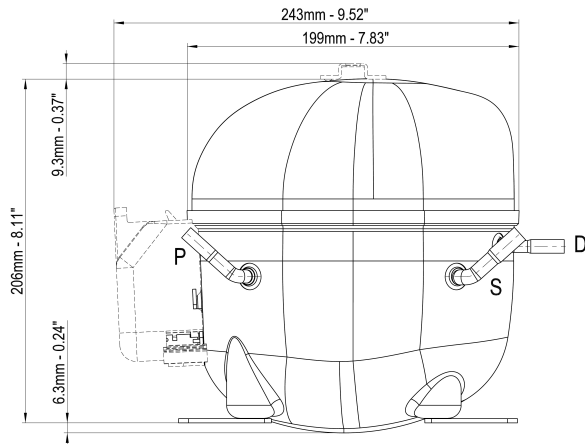

	∅ mm	∅ in	Material
S - Suction	8.10 - 8.20	0.32	Cu
P - Process	6.10 - 6.20	0.24	Cu
D - Discharge	6.10 - 6.20	0.24	Cu

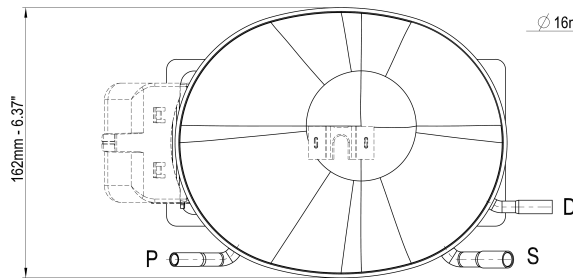

∅ 16mm - 0.63" (x6)

