

220-240V 50 1~**GENERAL DATA**

Application: LBP
Refrigerant: R290
Evaporating Temperature Range: -40°C to -10°C
Compressor Cooling: Fan
Fan air flow: 520 m³/h
Type: Hermetic reciprocating
Technology Type: On-Off
Expansion Device: Capillary Tube or Expansion Valve
Packing Quantity: Multi - 36 pcs
Displacement: 27.8 cm³
Horse power: 1.25 hp

Approvals:    

MECHANICAL DATA

Bore: 38.1 mm
Stroke: 24.4 mm
Oil Charge: 450ml +/-15ml
Free Internal Volume: 3.3 cm³
Maximum Recommended Refrigerant Charge: 150 g
Oil Type Configuration: Polyolester
Oil Type Viscosity: ISO22
Compressor pressurization: Without dry air charge
Weight: 18.6 kg

ELECTRICAL DATA

Motor Type: CSR
Starting Torque: HST
Voltage working range at 50 Hz: 198-254 V
Maximum Motor Temperature: 130 °C
Start Winding Resistance: 3.92 Ω (± 10%) at 25°C
Run Winding Resistance: 1.72 Ω (± 10%) at 25°C

MOUNTING ACCESSORIES

	Description	Code
Terminal Board:	no	-
Anchorage:	no	-
Overload Protector Bracket:	no	-
Capacitor Bracket:	no	-
Grommets:	yes	2221004
Sleeves:	yes	2222016
Washer:	no	-
Pin:	no	-
Clip:	no	-
Rotolock valve:	no	-
Cover:	yes	2075288

ELECTRICAL COMPONENTS

	Component type	Description	Code
Run Capacitor:		17.5 MFD	2253311
Motor Protection:	Internal	15HM1962	
Start Capacitor:		88-108 MFD 330V	2252269
Starting Device:	Potential relay	RVA2E3C-103	1253002
CSR / CSIR Box:	yes		1272342

EXTERNAL CHARACTERISTICS

Base Plate: Universal
Tray Holder: No
Height: 234 mm

	Internal Diameter (mm)	Material	Shape
Suction Connector	9.6	Copper	Vertical
Discharge Connector	6.42	Copper	Vertical
Process Connector	6.42	Copper	Vertical



RATED POINT DATA

Cooling Capacity (W)	Power Consumption (W)	Current Consumption (A)	Gas Flow Rate (kg/h)	Efficiency (W/W)
±5%	±5%	±5%	±5%	±7%
1 180	842	4.41	11.98	1.40

Test condition: ASHRAE, Fan, Return Gas 32.2°C, Evaporating: -23.3°C, Condensing: 54°C, Ambient: 32.2°C, Liquid: 32.2°C

PERFORMANCE CURVE DATA

220V 50Hz

Condensing Temperature (°C)	Evaporating Temperature (°C)	Cooling Capacity (W)	Power Consumption (W)	Current Consumption (A)	Gas Flow Rate (kg/h)	Efficiency (W/W)
		±5%	±5%	±5%	±5%	±7%
35°C	-10	2 329	1 001	5.09	23.91	2.33
	-15	1 921	911	4.71	19.64	2.11
	-20	1 561	825	4.35	15.89	1.89
	-25	1 249	742	4.01	12.68	1.68
	-30	987	662	3.69	9.99	1.49
	-35	774	586	3.40	7.82	1.32
	-40	612	513	3.14	6.16	1.19

Condensing Temperature (°C)	Evaporating Temperature (°C)	Cooling Capacity (W)	Power Consumption (W)	Current Consumption (A)	Gas Flow Rate (kg/h)	Efficiency (W/W)
		±5%	±5%	±5%	±5%	±7%
45°C	-10	2 200	1 077	5.41	22.59	2.04
	-15	1 809	972	4.96	18.49	1.86
	-20	1 462	872	4.54	14.89	1.68
	-25	1 161	776	4.15	11.78	1.50
	-30	907	684	3.79	9.17	1.33
	-35	698	596	3.46	7.05	1.17

Condensing Temperature (°C)	Evaporating Temperature (°C)	Cooling Capacity (W)	Power Consumption (W)	Current Consumption (A)	Gas Flow Rate (kg/h)	Efficiency (W/W)
		±5%	±5%	±5%	±5%	±7%
55°C	-10	2 069	1 151	5.73	21.24	1.80
	-15	1 697	1 032	5.21	17.34	1.64
	-20	1 366	918	4.73	13.90	1.49
	-25	1 078	808	4.28	10.94	1.33
	-30	833	704	3.86	8.43	1.18

Test condition: ASHRAE, Fan, Return Gas 32.2°C, Ambient: 32.2°C, Liquid: 32.2°C

ASSEMBLY INSTRUCTION

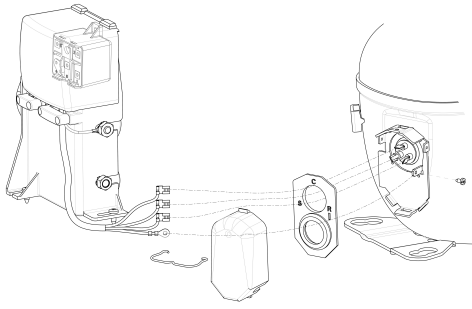

WIRING DIAGRAM

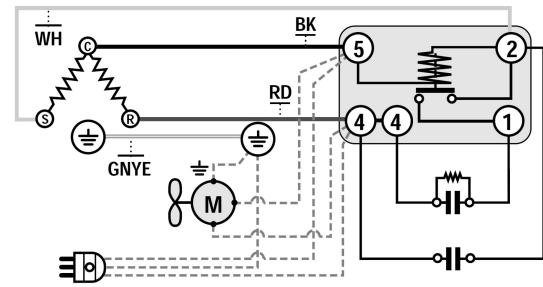

OPERATING ENVELOPE

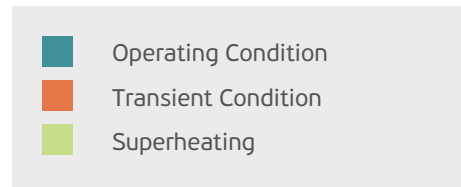
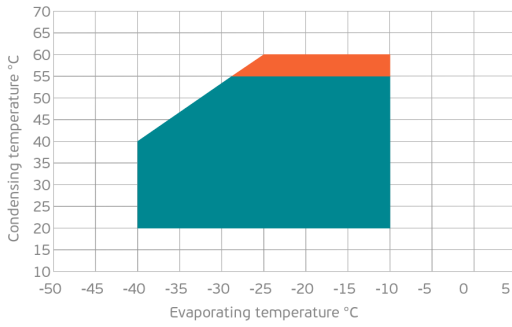

NOTE: usage of compressors outside of intended working range cannot make use of the warranty, or should be consulted with Technical support.

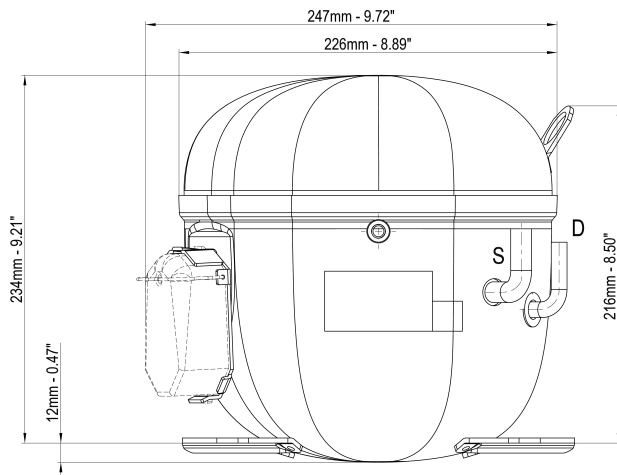

	∅ mm	∅ in	Material
S - Suction	9.60	0.37	Cu
P - Process	6.42	0.25	Cu
D - Discharge	6.42	0.25	Cu

