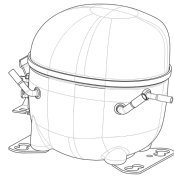

115V 60 1~**GENERAL DATA**

Application: LBP
Refrigerant: R134a
Evaporating Temperature Range: -30°C to -5°C
Compressor Cooling: Fan
Fan air flow: 520 m³/h
Type: Hermetic reciprocating
Technology Type: On-Off
Expansion Device: Capillary Tube or Expansion Valve
Packing Quantity: Multi - 37 pcs
Displacement: 14.28 cm³
Horse power: 1.3 hp

Approvals:   

MECHANICAL DATA

Bore: 30.16 mm
Stroke: 20 mm
Oil Charge: 350ml +/-15ml
Free Internal Volume: 2.1 cm³
Maximum Recommended Refrigerant Charge: 350 g
Oil Type Configuration: Polyolester
Oil Type Viscosity: ISO22
Compressor pressurization: Dry air charge
Weight: 11 kg

ELECTRICAL DATA

Motor Type: CSIR
Starting Torque: HST
Voltage working range at 60 Hz: 103-127 V
Maximum Motor Temperature: 130 °C
Start Winding Resistance: 6.1 Ω (± 10%) at 25°C
Run Winding Resistance: 0.96 Ω (± 10%) at 25°C
Locked Rotor Amperage (LRA): 33 A

MOUNTING ACCESSORIES

	Description	Code
Terminal Board:	no	-
Anchorage:	no	-
Washer:	no	-
Pin:	no	-
Clip:	no	-
Rotolock valve:	no	-
Overload Protector Bracket:	yes	2075299
Cover:	yes	2075278
Grommets:	yes	2221003
Sleeves:	yes	2222015
Capacitor Bracket:	yes	2255006

ELECTRICAL COMPONENTS

	Component type	Description	Code
Starting Device:	Current relay	MTRPH-64-31	2271161
Motor Protection:	External 3/4"	T0625/J5	2324025
Start Capacitor:		189-227 MFD 250V	2252324

EXTERNAL CHARACTERISTICS

Base Plate: Universal
Tray Holder: No
Height: 200 mm

	Internal Diameter (mm)	Material	Shape
Suction Connector	8.1	Copper	Slanted 42°
Discharge Connector	6.45	Copper	Straight
Process Connector	6.45	Copper	Slanted 42°

RATED POINT DATA

Cooling Capacity (W)	Power Consumption (W)	Current Consumption (A)	Gas Flow Rate (kg/h)	Efficiency (W/W)
±5%	±5%	±5%	±5%	±7%
415	346	5.33	8.04	1.20

Test condition: ASHRAE, Fan, Return Gas 32.2°C, Evaporating: -23.3°C, Condensing: 54°C, Ambient: 32.2°C, Liquid: 32.2°C

PERFORMANCE CURVE DATA

115V 60Hz

Condensing Temperature (°C)	Evaporating Temperature (°C)	Cooling Capacity (W)	Power Consumption (W)	Current Consumption (A)	Gas Flow Rate (kg/h)	Efficiency (W/W)
		±5%	±5%	±5%	±5%	±7%
35°C	-5	1 032	479	6.15	20.26	2.15
	-10	837	437	5.87	16.36	1.91
	-15	673	396	5.61	13.10	1.70
	-20	534	355	5.38	10.37	1.51
	-25	416	314	5.16	8.06	1.33
	-30	315	273	4.95	6.08	1.15

Condensing Temperature (°C)	Evaporating Temperature (°C)	Cooling Capacity (W)	Power Consumption (W)	Current Consumption (A)	Gas Flow Rate (kg/h)	Efficiency (W/W)
		±5%	±5%	±5%	±5%	±7%
45°C	-5	1 007	517	6.42	19.76	1.95
	-10	812	465	6.05	15.88	1.75
	-15	649	415	5.73	12.64	1.56
	-20	512	368	5.45	9.94	1.39
	-25	396	322	5.20	7.68	1.23
	-30	297	279	4.98	5.74	1.06

Condensing Temperature (°C)	Evaporating Temperature (°C)	Cooling Capacity (W)	Power Consumption (W)	Current Consumption (A)	Gas Flow Rate (kg/h)	Efficiency (W/W)
		±5%	±5%	±5%	±5%	±7%
55°C	-5	982	555	6.69	19.26	1.77
	-10	788	492	6.24	15.40	1.60
	-15	626	434	5.85	12.18	1.44
	-20	490	380	5.52	9.51	1.29
	-25	376	331	5.24	7.29	1.14

Test condition: ASHRAE, Fan, Return Gas 32.2°C, Ambient: 32.2°C, Liquid: 32.2°C

ASSEMBLY INSTRUCTION

WIRING DIAGRAM

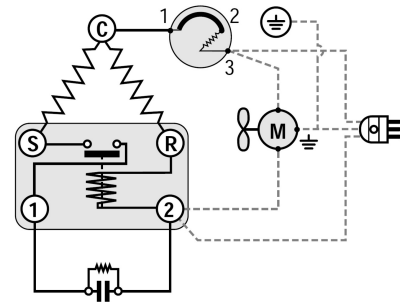
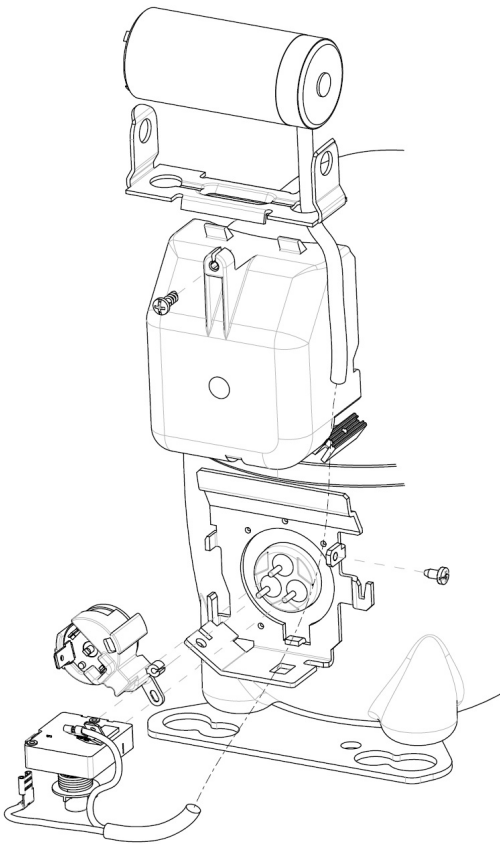

OPERATING ENVELOPE

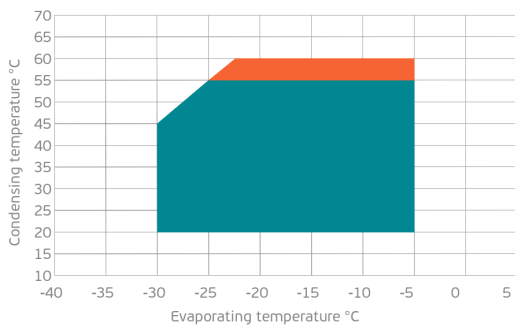

- Operating Condition
- Transient Condition
- Superheating

NOTE: usage of compressors outside of intended working range cannot make use of the warranty, or should be consulted with Technical support.

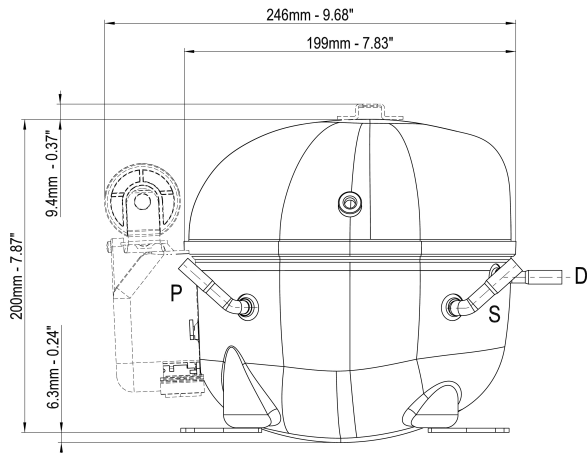

	∅ mm	∅ in	Material
S - Suction	8.10 - 8.20	0.32	Cu
P - Process	6.45 - 6.55	0.25	Cu
D - Discharge	6.45 - 6.55	0.25	Cu

