

220-240V 50 1~



**GENERAL DATA**

**Application:** M/HBP  
**Refrigerant:** R404A  
**Evaporating Temperature Range:** -20°C to 10°C  
**Compressor Cooling:** Fan  
**Fan air flow:** 800 m<sup>3</sup>/h  
**Type:** Hermetic reciprocating  
**Technology Type:** On-Off  
**Expansion Device:** Capillary Tube or Expansion Valve  
**Packing Quantity:** Multi - 36 pcs  
**Displacement:** 26.1 cm<sup>3</sup>  
**Horse power:** 1.5 hp

Approvals:     



**MECHANICAL DATA**

**Bore:** 41.77 mm  
**Stroke:** 19.07 mm  
**Oil Charge:** 750ml +/-15ml  
**Free Internal Volume:** 3.9 cm<sup>3</sup>  
**Maximum Recommended Refrigerant Charge:** 800 g  
**Oil Type Configuration:** Polyolester  
**Oil Type Viscosity:** ISO22  
**Compressor pressurization:** Dry air charge  
**Weight:** 22.5 kg

**ELECTRICAL DATA**

**Motor Type:** CSR  
**Starting Torque:** HST  
**Voltage working range at 50 Hz:** 198-254 V  
**Maximum Motor Temperature:** 130 °C  
**Start Winding Resistance:** 5.4 Ω (± 10%) at 25°C  
**Run Winding Resistance:** 1.75 Ω (± 10%) at 25°C

**MOUNTING ACCESSORIES**

	Description	Code
<b>Cover:</b>	yes	2075281
<b>Terminal Board:</b>	no	-
<b>Anchorage:</b>	no	-
<b>Overload Protector Bracket:</b>	no	-
<b>Capacitor Bracket:</b>	no	-
<b>Grommets:</b>	yes	2221004
<b>Sleeves:</b>	yes	2222016
<b>Washer:</b>	no	-
<b>Pin:</b>	no	-
<b>Clip:</b>	no	-
<b>Rotolock valve:</b>	no	-

**ELECTRICAL COMPONENTS**

	Component type	Description	Code
<b>Start Capacitor:</b>		88-108 MFD 330V	2252269
<b>Starting Device:</b>	Potential relay	RVA3H3C-108	1253007
<b>Run Capacitor:</b>		30 MFD	2253314
<b>Motor Protection:</b>	External 3/4"	T0809/C9	2289028
<b>CSR / CSIR Box:</b>	yes		1262198

**EXTERNAL CHARACTERISTICS**

**Base Plate:** Large  
**Tray Holder:** No  
**Height:** 276 mm

	Internal Diameter (mm)	Material	Shape
<b>Suction Connector</b>	12.77	Copper	Vertical
<b>Discharge Connector</b>	8	Copper	Slanted 65°

**RATED POINT DATA**

Cooling Capacity (W)	Power Consumption (W)	Current Consumption (A)	Gas Flow Rate (kg/h)	Efficiency (W/W)
±5%	±5%	±5%	±5%	±7%
1 911	1 172	5.66	57.38	1.63

Test condition: EN 12900, Fan, Return Gas 20°C, Subcooling OK, Evaporating: -10°C, Condensing: 45°C, Ambient: 35°C

**PERFORMANCE CURVE DATA****220V 50Hz**

Condensing Temperature (°C)	Evaporating Temperature (°C)	Cooling Capacity (W)	Power Consumption (W)	Current Consumption (A)	Gas Flow Rate (kg/h)	Efficiency (W/W)
		±5%	±5%	±5%	±5%	±7%
<b>35°C</b>	10	5 125	1 465	6.96	142.48	3.50
	5	4 349	1 387	6.57	119.00	3.14
	0	3 633	1 305	6.20	98.00	2.78
	-5	2 980	1 220	5.83	79.39	2.44
	-10	2 393	1 132	5.46	63.09	2.11
	-15	1 876	1 042	5.08	49.01	1.80
	-20	1 430	949	4.68	37.07	1.51

Condensing Temperature (°C)	Evaporating Temperature (°C)	Cooling Capacity (W)	Power Consumption (W)	Current Consumption (A)	Gas Flow Rate (kg/h)	Efficiency (W/W)
		±5%	±5%	±5%	±5%	±7%
<b>45°C</b>	10	4 256	1 595	7.67	135.89	2.67
	5	3 589	1 489	7.12	112.53	2.41
	0	2 974	1 383	6.61	91.71	2.15
	-5	2 413	1 277	6.12	73.36	1.89
	-10	1 911	1 172	5.66	57.38	1.63
	-15	1 470	1 067	5.19	43.69	1.38
	-20	1 093	964	4.73	32.21	1.13

Condensing Temperature (°C)	Evaporating Temperature (°C)	Cooling Capacity (W)	Power Consumption (W)	Current Consumption (A)	Gas Flow Rate (kg/h)	Efficiency (W/W)
		±5%	±5%	±5%	±5%	±7%
<b>55°C</b>	10	3 317	1 715	8.29	126.13	1.93
	5	2 772	1 581	7.59	103.28	1.75
	0	2 271	1 450	6.96	83.06	1.57
	-5	1 818	1 323	6.37	65.36	1.37
	-10	1 414	1 199	5.81	50.12	1.18

Test condition: EN 12900, Fan, Return Gas 20°C, Subcooling OK, Ambient: 35°C

**ASSEMBLY INSTRUCTION**

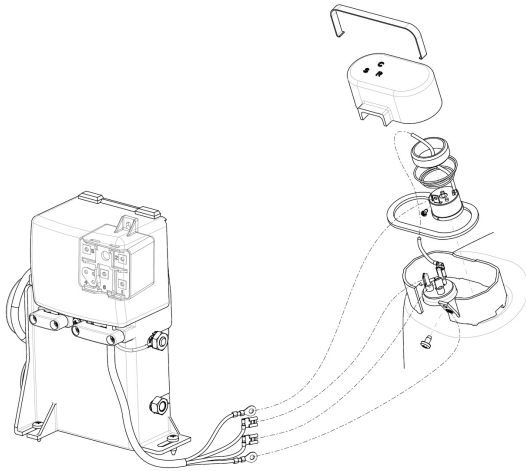

**WIRING DIAGRAM**

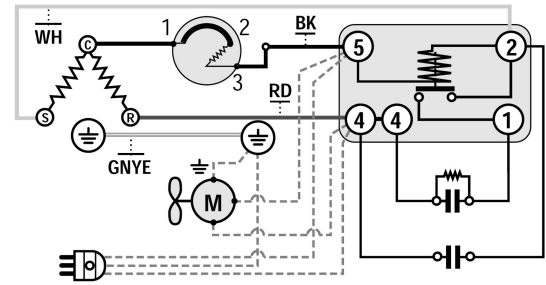

**OPERATING ENVELOPE**

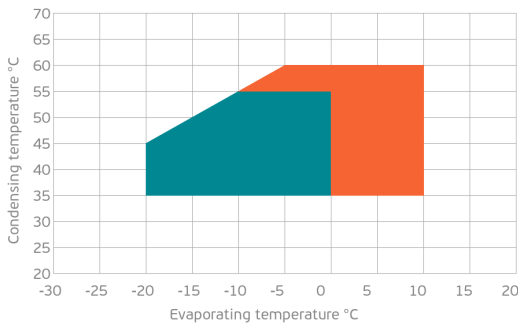

- Operating Condition
- Transient Condition
- Superheating

**NOTE:** usage of compressors outside of intended working range cannot make use of the warranty, or should be consulted with Technical support.

