

380-420V 50 / 440-480V 60Hz 3~**GENERAL DATA**

Application: LBP
Refrigerant: R404A
Evaporating Temperature Range: -40°C to -10°C
Compressor Cooling: Fan
Fan air flow: 800 m³/h
Type: Hermetic reciprocating
Technology Type: On-Off
Expansion Device: Capillary Tube or Expansion Valve
Packing Quantity: Single - 1 pc
Displacement: 34.4 cm³
Horse power: 1.5 hp

**MECHANICAL DATA**

Bore: 42.85 mm
Stroke: 23.85 mm
Oil Charge: 750ml +/-15ml
Free Internal Volume: 3.9 cm³
Maximum Recommended Refrigerant Charge: 800 g
Oil Type Configuration: Polyolester
Oil Type Viscosity: ISO22
Compressor pressurization: Dry air charge
Weight: 21.1 kg

ELECTRICAL DATA

Motor Type: 3PHASE
Starting Torque: HST
Voltage working range at 50 Hz: 332-445 V
Voltage working range at 60 Hz: 396-509 V
Maximum Motor Temperature: 130 °C
Run Winding Resistance: 9.04 Ω (± 10%) at 25°C
Locked Rotor Amperage (LRA): 21 A

MOUNTING ACCESSORIES

	Description	Code
Cover:	yes	2075281
Terminal Board:	no	-
Anchorage:	no	-
Overload Protector Bracket:	no	-
Capacitor Bracket:	no	-
Grommets:	yes	2221004
Sleeves:	yes	2222016
Washer:	no	-
Pin:	no	-
Clip:	no	-
Rotolock valve:	no	-

ELECTRICAL COMPONENTS

Component type	Description	Code
Motor Protection: Internal		34HM260

EXTERNAL CHARACTERISTICS

Base Plate: Large
Tray Holder: No
Height: 276 mm

	Internal Diameter (mm)	Material	Shape
Suction Connector	12.77	Copper	Vertical
Discharge Connector	8	Copper	Slanted 65°

RATED POINT DATA

Cooling Capacity (W)	Power Consumption (W)	Current Consumption (A)	Gas Flow Rate (kg/h)	Efficiency (W/W)
±5%	±5%	±5%	±5%	±7%
1 487	1 120	2.36	34.40	1.33

Test condition: ASHRAE, Fan, Return Gas 32.2°C, Evaporating: -23.3°C, Condensing: 54°C, Ambient: 32.2°C, Liquid: 32.2°C

PERFORMANCE CURVE DATA

380V 50Hz

Condensing Temperature (°C)	Evaporating Temperature (°C)	Cooling Capacity (W)	Power Consumption (W)	Current Consumption (A)	Gas Flow Rate (kg/h)	Efficiency (W/W)
		±5%	±5%	±5%	±5%	±7%
35°C	-10	3 312	1 456	2.83	78.19	2.28
	-15	2 703	1 316	2.63	63.36	2.05
	-20	2 163	1 176	2.44	50.39	1.84
	-25	1 692	1 036	2.27	39.22	1.63
	-30	1 291	896	2.12	29.80	1.44
	-35	960	756	1.98	22.08	1.27
	-40	697	616	1.85	16.00	1.13

Condensing Temperature (°C)	Evaporating Temperature (°C)	Cooling Capacity (W)	Power Consumption (W)	Current Consumption (A)	Gas Flow Rate (kg/h)	Efficiency (W/W)
		±5%	±5%	±5%	±5%	±7%
45°C	-10	3 112	1 596	3.02	73.31	1.95
	-15	2 524	1 416	2.76	59.05	1.78
	-20	2 001	1 240	2.52	46.53	1.61
	-25	1 543	1 068	2.30	35.69	1.45
	-30	1 150	899	2.11	26.50	1.28
	-35	822	734	1.94	18.88	1.12

Condensing Temperature (°C)	Evaporating Temperature (°C)	Cooling Capacity (W)	Power Consumption (W)	Current Consumption (A)	Gas Flow Rate (kg/h)	Efficiency (W/W)
		±5%	±5%	±5%	±5%	±7%
55°C	-10	2 796	1 675	3.11	65.74	1.67
	-15	2 243	1 459	2.80	52.38	1.54
	-20	1 752	1 250	2.52	40.65	1.40
	-25	1 321	1 049	2.28	30.50	1.26
	-30	951	855	2.08	21.87	1.11

Test condition: ASHRAE, Fan, Return Gas 32.2°C, Ambient: 32.2°C, Liquid: 32.2°C

ASSEMBLY INSTRUCTION

WIRING DIAGRAM

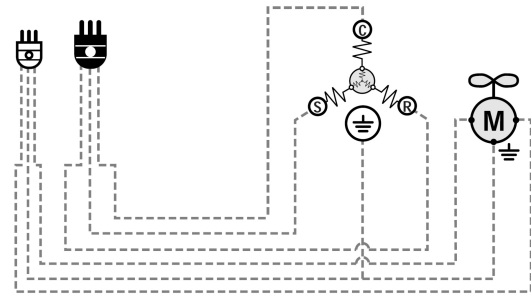
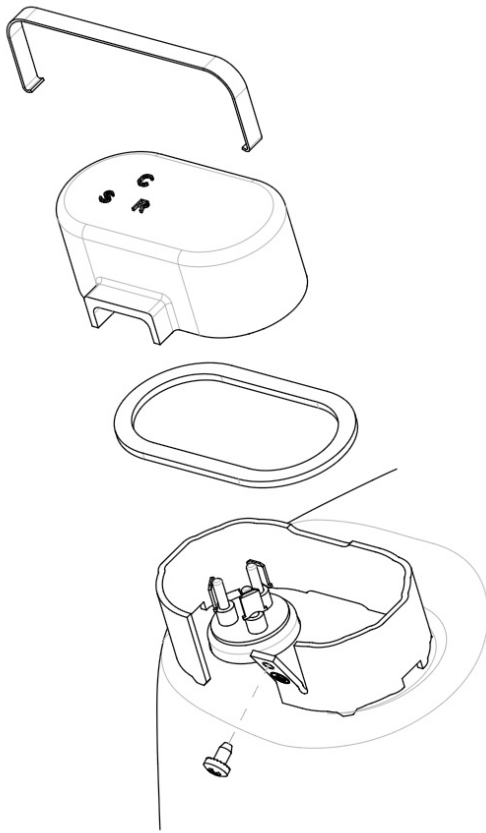

OPERATING ENVELOPE

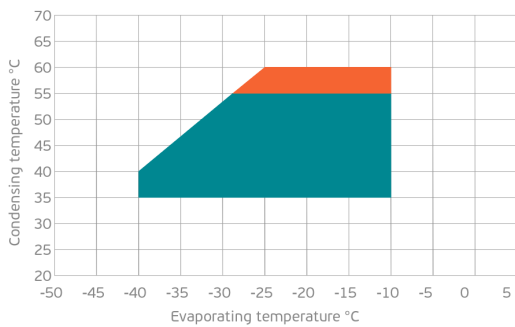

- Operating Condition
- Transient Condition
- Superheating

NOTE: usage of compressors outside of intended working range cannot make use of the warranty, or should be consulted with Technical support.

