

200-220V 50 / 230V 60Hz 1~

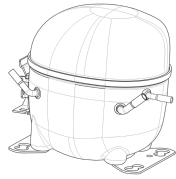

GENERAL DATA

Application: LBP
Refrigerant: R134a
Evaporating Temperature Range: -30°C to -5°C
Compressor Cooling: Fan
Fan air flow: 520 m³/h
Type: Hermetic reciprocating
Technology Type: On-Off
Expansion Device: Capillary Tube or Expansion Valve
Packing Quantity: Multi - 37 pcs
Displacement: 9.26 cm³
Horse power: 1.4 hp

Approvals:    

MECHANICAL DATA

Bore: 24.28 mm
Stroke: 20 mm
Oil Charge: 350ml +/-15ml
Free Internal Volume: 2.1 cm³
Maximum Recommended Refrigerant Charge: 350 g
Oil Type Configuration: Polyolester
Oil Type Viscosity: ISO22
Compressor pressurization: Dry air charge
Weight: 11.5 kg

ELECTRICAL DATA

Motor Type: CSIR
Starting Torque: HST
Voltage working range at 50 Hz: 180-254 V
Voltage working range at 60 Hz: 207-253 V
Maximum Motor Temperature: 130 °C
Start Winding Resistance: 19.68 Ω (± 10%) at 25°C
Run Winding Resistance: 5.37 Ω (± 10%) at 25°C

MOUNTING ACCESSORIES

	Description	Code
Anchorage:	no	-
Overload Protector Bracket:	no	-
Capacitor Bracket:	no	-
Rotolock valve:	no	-
Sleeves:	no	-
Cover:	yes	2075282
Grommets:	yes	2221011
Washer:	yes	2211047
Pin:	yes	2037140
Clip:	yes	2220020
Terminal Board:	yes	1027060

ELECTRICAL COMPONENTS

	Component type	Description	Code
Starting Device:	Current relay	MTRP-0027-65	2334107
Motor Protection:	External	4TM743LFBYY-153	2316020
Start Capacitor:		64-77 MFD 330V	2252352

EXTERNAL CHARACTERISTICS

Base Plate: European
Tray Holder: No
Height: 206 mm

	Internal Diameter (mm)	Material	Shape
Suction Connector	8.1	Copper	Slanted 42°
Discharge Connector	6.1	Copper	Straight
Process Connector	6.1	Copper	Slanted 42°

RATED POINT DATA

Cooling Capacity (W)	Power Consumption (W)	Current Consumption (A)	Gas Flow Rate (kg/h)	Efficiency (W/W)
±5%	±5%	±5%	±5%	±7%
298	231	1.93	5.78	1.29

Test condition: ASHRAE, Fan, Return Gas 32.2°C, Evaporating: -23.3°C, Condensing: 54°C, Ambient: 32.2°C, Liquid: 32.2°C

PERFORMANCE CURVE DATA

200V 50Hz

Condensing Temperature (°C)	Evaporating Temperature (°C)	Cooling Capacity (W)	Power Consumption (W)	Current Consumption (A)	Gas Flow Rate (kg/h)	Efficiency (W/W)
		±5%	±5%	±5%	±5%	±7%
35°C	-5	776	322	2.24	15.23	2.41
	-10	633	293	2.15	12.38	2.16
	-15	508	266	2.06	9.90	1.91
	-20	400	240	1.97	7.76	1.67
	-25	308	214	1.89	5.97	1.44
	-30	234	190	1.81	4.52	1.23

Condensing Temperature (°C)	Evaporating Temperature (°C)	Cooling Capacity (W)	Power Consumption (W)	Current Consumption (A)	Gas Flow Rate (kg/h)	Efficiency (W/W)
		±5%	±5%	±5%	±5%	±7%
45°C	-5	749	346	2.32	14.70	2.16
	-10	608	312	2.19	11.88	1.95
	-15	484	279	2.08	9.42	1.74
	-20	377	247	1.98	7.33	1.53
	-25	288	218	1.90	5.58	1.32
	-30	216	190	1.83	4.18	1.14

Condensing Temperature (°C)	Evaporating Temperature (°C)	Cooling Capacity (W)	Power Consumption (W)	Current Consumption (A)	Gas Flow Rate (kg/h)	Efficiency (W/W)
		±5%	±5%	±5%	±5%	±7%
55°C	-5	724	370	2.40	14.20	1.96
	-10	583	329	2.24	11.40	1.77
	-15	460	290	2.10	8.97	1.59
	-20	356	254	1.99	6.90	1.40
	-25	268	221	1.91	5.20	1.22

Test condition: ASHRAE, Fan, Return Gas 32.2°C, Ambient: 32.2°C, Liquid: 32.2°C

ASSEMBLY INSTRUCTION

WIRING DIAGRAM

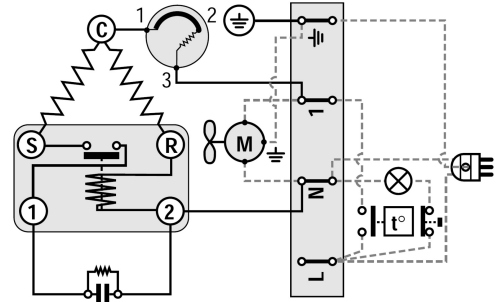
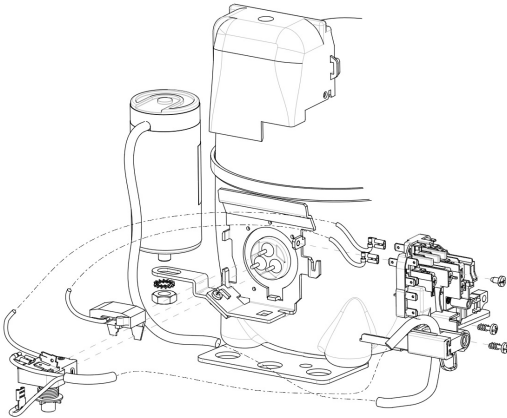

OPERATING ENVELOPE

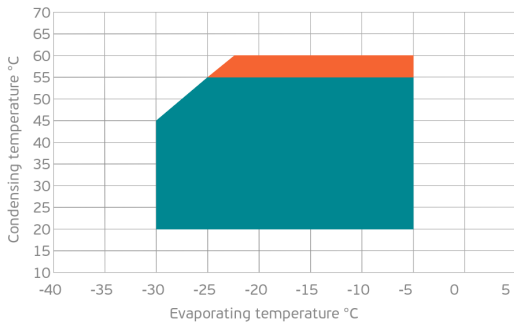

- Operating Condition
- Transient Condition
- Superheating

NOTE: usage of compressors outside of intended working range cannot make use of the warranty, or should be consulted with Technical support.

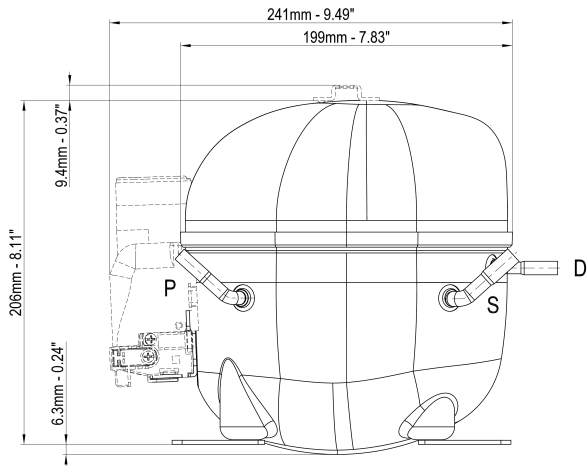

	∅ mm	∅ in	Material
S - Suction	8.10 - 8.20	0.32	Cu
P - Process	6.10 - 6.20	0.24	Cu
D - Discharge	6.10 - 6.20	0.24	Cu

