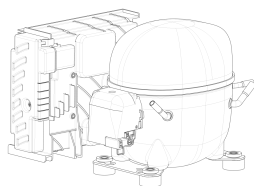

**220-240V 1~****GENERAL DATA**

**Application:** LBP  
**Refrigerant:** R290  
**Evaporating Temperature Range:** -40°C to -10°C  
**Compressor Cooling:** Fan  
**Fan air flow:** 520 m<sup>3</sup>/h  
**Type:** Hermetic reciprocating  
**Technology Type:** VCC  
**Expansion Device:** Capillary Tube or Expansion Valve  
**Packing Quantity:** Multi - 40 pcs  
**Displacement:** 16.8 cm<sup>3</sup>

Approvals:    

**MECHANICAL DATA**

**Bore:** 31.19 mm  
**Stroke:** 22 mm  
**Oil Charge:** 500ml +/-15ml  
**Free Internal Volume:** 2.1 cm<sup>3</sup>  
**Maximum Recommended Refrigerant Charge:** 150 g  
**Oil Type Configuration:** Polyolester  
**Oil Type Viscosity:** ISO22  
**Compressor pressurization:** Without dry air charge  
**Weight:** 14.1 kg

**ELECTRICAL DATA**

**Motor Type:** BPM  
**Starting Torque:** HST  
**Voltage working range at 50 Hz:** 150 (160)-240 V  
**Voltage working range at 60 Hz:** 150 (160) V  
**Maximum Motor Temperature:** 130 °C  
**Start Winding Resistance:** 3.82 Ω (± 10%) at 25°C  
**Run Winding Resistance:** 2.53 Ω (± 10%) at 25°C  
**Locked Rotor Amperage (LRA):** 6 A

**MOUNTING ACCESSORIES**

	Description	Code
<b>Terminal Board:</b>	no	-
<b>Capacitor Bracket:</b>	no	-
<b>Grommets:</b>	yes	2221004
<b>Sleeves:</b>	yes	2222016
<b>Washer:</b>	no	-
<b>Pin:</b>	no	-
<b>Clip:</b>	no	-
<b>Rotolock valve:</b>	no	-
<b>Cover:</b>	yes	2075282
<b>Anchorage:</b>	yes	1027058
<b>Overload Protector Bracket:</b>	yes	2075299

**ELECTRICAL COMPONENTS**

	Component type	Description	Code
<b>Inverter:</b>	HP DROP IN	1000W 220V	519302020
<b>Motor Protection:</b>	External 3/4"	T0624/07   MST26AKK-3166	2288100   2288318

**EXTERNAL CHARACTERISTICS**

**Base Plate:** Universal  
**Tray Holder:** No  
**Height:** 206 mm

	Internal Diameter (mm)	Material	Shape
<b>Suction Connector</b>	8.1	Copper	Slanted 42°
<b>Discharge Connector</b>	6.45	Copper	Straight
<b>Process Connector</b>	6.45	Copper	Slanted 42°



**RATED POINT DATA**

Cooling Capacity (W)	Power Consumption (W)	Current Consumption (A)	Gas Flow Rate (kg/h)	Efficiency (W/W)
±5%	±5%	±5%	±5%	±7%
347	271	1.27	3.73	1.28

Test condition: EN 12900, Fan, Return Gas 20°C, Subcooling OK, Evaporating: -35°C, Condensing: 40°C, Ambient: 35°C

**PERFORMANCE CURVE DATA**

**2000 RPM**

Condensing Temperature (°C)	Evaporating Temperature (°C)	Cooling Capacity (W)	Power Consumption (W)	Current Consumption (A)	Gas Flow Rate (kg/h)	Efficiency (W/W)
		±5%	±5%	±5%	±5%	±7%
<b>35°C</b>	-10	1 132	423	1.98	11.90	2.67
	-15	938	396	1.85	9.83	2.37
	-20	765	365	1.71	7.98	2.10
	-25	612	332	1.56	6.36	1.85
	-30	481	298	1.41	4.98	1.62
	-35	373	264	1.25	3.86	1.41
	-40	289	233	1.11	2.98	1.24

Condensing Temperature (°C)	Evaporating Temperature (°C)	Cooling Capacity (W)	Power Consumption (W)	Current Consumption (A)	Gas Flow Rate (kg/h)	Efficiency (W/W)
		±5%	±5%	±5%	±5%	±7%
<b>45°C</b>	-10	965	464	2.15	11.09	2.08
	-15	806	431	1.99	9.21	1.87
	-20	660	395	1.83	7.52	1.67
	-25	530	357	1.65	6.02	1.49
	-30	417	318	1.47	4.72	1.31
	-35	321	279	1.29	3.61	1.15

Condensing Temperature (°C)	Evaporating Temperature (°C)	Cooling Capacity (W)	Power Consumption (W)	Current Consumption (A)	Gas Flow Rate (kg/h)	Efficiency (W/W)
		±5%	±5%	±5%	±5%	±7%
<b>55°C</b>	-10	820	510	2.33	10.44	1.61
	-15	690	472	2.16	8.74	1.46
	-20	569	430	1.96	7.18	1.32
	-25	459	385	1.76	5.76	1.19
	-30	359	340	1.55	4.49	1.06

Test condition: EN 12900, Fan, Return Gas 20°C, Subcooling OK, Ambient: 35°C

**ASSEMBLY INSTRUCTION**

**WIRING DIAGRAM**

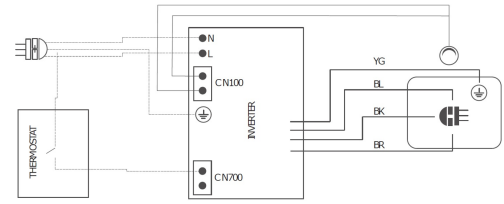
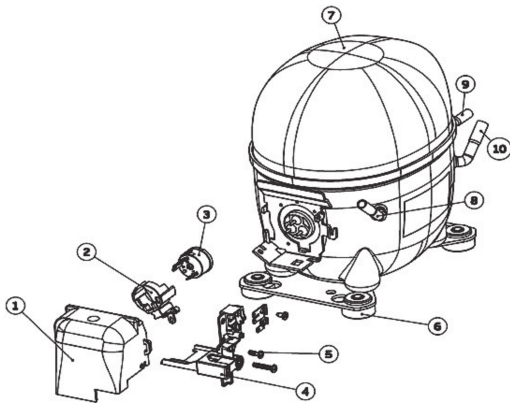

**OPERATING ENVELOPE**

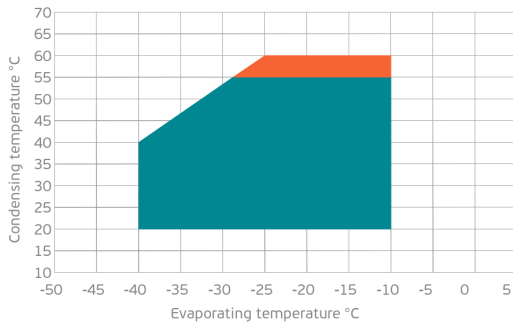

- Operating Condition
- Transient Condition
- Superheating

**NOTE:** usage of compressors outside of intended working range cannot make use of the warranty, or should be consulted with Technical support.

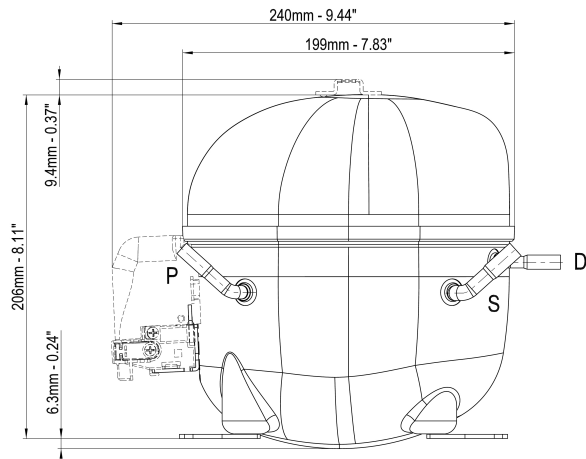

	∅ mm	∅ in	Material
<b>S - Suction</b>	8.10 - 8.20	0.32	Cu
<b>P - Process</b>	6.45 - 6.55	0.25	Cu
<b>D - Discharge</b>	6.45 - 6.55	0.25	Cu

